

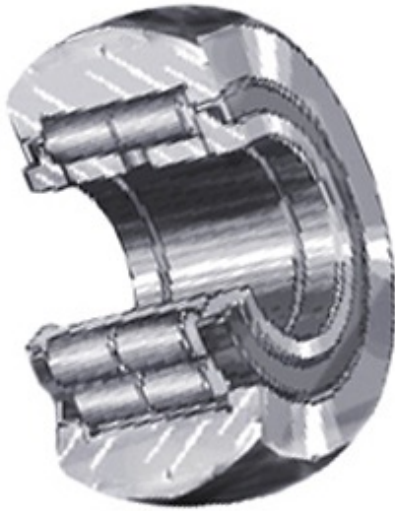

NTN BEARING DRIVESHAFT, INC.

INA NUTR50110 Mounted Units & Inserts



NUTR50110 Bearing 2D drawings and 3D CAD models

Bearing No. NUTR50110

| | |
|------------------------|---|
| Category | Cam Follower and Track Roller - Yoke Type |
| Inventory | 1.0 |
| Manufacturer Name | SCHAEFFLER GROUP |
| Minimum Buy Quantity | N/A |
| Weight | 1.69 |
| EAN | 4047643156073 |
| Product Group | B04120 |
| Roller Surface Profile | Crowned |
| Profile | Yoke Type |
| Enclosure | Sealed |
| Rolling Element | Cylindrical Roller Bearing - Double Row |
| Relubricatable | Yes |
| Inch - Metric | Metric |
| Other Features | Full Complement With Inner Ring Labyrinth Seal |
| Long Description | 50MM Bore; 110MM Roller Diameter; 30MM Roller Width; Crowned Roller; Yoke Type; Sealed; Cylindrical Roller Bearing - Double Row; Relubricatable |
| Category | Cam Followers Yoke Type |
| UNSPSC | 31171530 |
| Harmonized Tariff Code | 8482.50.00.00 |
| Noun | Bearing |
| Keyword String | Cam Follower |
| Manufacturer URL | http://www.ina.com |



NTN BEARING DRIVESHAFT,INC.

| | |
|--------------------------|-----------------------------|
| Manufacturer Item Number | NUTR50110 |
| Weight / LBS | 3.726 |
| d | 1.969 Inch 50 Millimeter |
| Roller Diameter | 4.331 Inch 110 Millimeter |
| Roller Width | 1.181 Inch 30 Millimeter |